

Type Number..... 377
Designation IEC..... SR66
System..... Silver oxide/ Zinc /
 NaOH - Electrolyte

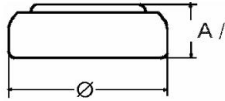

Nominal Voltage..... 1,55 V
Typical Capacity C..... 21 mAh
 47 k Ω load at 20°C down to 1,2 Volts

Weight (approx.)..... 0,34 g
Volume..... 0,09 ccm

Temperature Ranges min max.
 Storage..... 0°C 60°C
 Discharge..... 0°C 60°C

Dimensions min max.
 Diameter..... 6,6 mm 6,8 mm
 Height (A/B)..... 2,4 mm 2,6 mm

Segment..... Watch

Typical Capacities (at 20°C)

Discharge Type	Load	End Voltage:	1.2 V	V
Continuous 24h/d, 7d/w	47000 Ω	Time:	710	h
		Capacity	21	mAh
		Energy :	30	mWh

No publication or circulation of data to third parties without consent of VARTA Consumer Batteries

All Data contained herein is for single cells For battery applications, performance data may vary from single cell data, depending on specific battery configuration